

SPRING PINS Slotted, Heavy Duty to ISO 8752

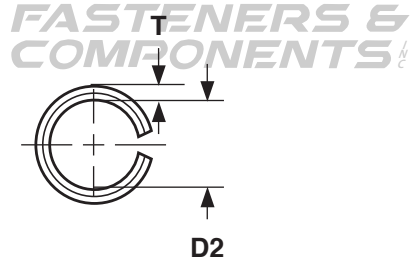
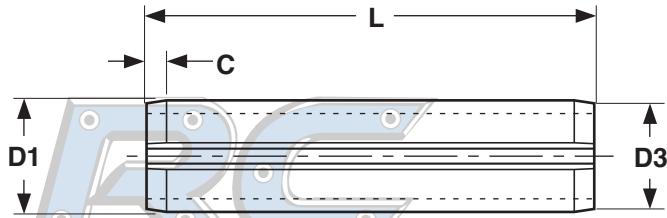

METRIC SPRING PINS, SLOTTED HEAVY DUTY

ISO 8752

Nominal Pin Diameter	D1		D2	C		T	Double Shear Load, kN
	Outside Diameter, before Mounting		Inside Diameter, before Mounting	Chamfer Length		Stock Thickness	
	Max	Min	Nom	Max	Min	Basic	Min
M2	2.4	2.3	1.5	0.55	0.35	0.4	2.82
M2.5	2.9	2.8	1.8	0.6	0.4	0.5	4.38
M3	3.5	3.3	2.1	0.7	0.5	0.6	6.32
M3.5	4.0	3.8	2.3	0.8	0.6	0.75	9.06
M4	4.6	4.4	2.8	0.85	0.65	0.8	11.24
M4.5	5.1	4.9	2.9	1.0	0.8	1	15.36
M5	5.6	5.4	3.4	1.1	0.9	1	17.54
M6	6.7	6.4	4	1.4	1.2	1.2	26.04
M8	8.8	8.5	5.5	2.0	1.6	1.5	42.76

Tolerance on Length	Nominal Pin Length		
	M4 to M10	M12 to M50	M55 to M200
	± 0.25	±0.50	±0.75

Description	A hollow, headless pin, slit longitudinally, having controlled length with chamfered ends, formed to a diameter somewhat greater than that of the hole into which it is to be assembled.
Applications/ Advantages	Will hold its position in an assembly by a predetermined spring tension. Spring pins are economical because they can simplify product design by replacing more expensive fasteners such as taper pins, set screws and straight pins.
Material	<i>Carbon Steel: Carbon: 0.65% minimum; Manganese: 0.5% minimum</i>
Hardness	Hardened and tempered to a Vickers hardness of 420 HV30 to 560 HV30.
Shear Load	Spring pins shall be capable of withstanding the minimum double shear loads specified in the above table.
Finish	See Appendix-A for information about the coating of spring pins.