

Slide / Push



Access fasteners that operate by slide/push action are growing in popularity. This is due, in part, to the simplicity and speed of the operating motion. At the same time, slide/push-action fasteners share a tolerance for thickness variation of the fastened parts.

The DFCI fasteners in this section are some of the most convenient to operate of the type that secures panels over supports.

Slide / Push



Latch body and snap clip ordered separately.

8404 Slide Latch

The 8404 Plastic Slide Latch is held in the closed position by spring tension. A stainless steel spring is nested at the back end of the one-piece latch body, and contacts the back edge of the panel hole.

When the panel is pushed closed, the sloped pawl edge meets the support corner and slides the latch back. As the panel closes fully, the pawl clears the edge of the support and the spring slides the latch forward to the closed position.

Sliding the latch back with a finger opens the panel.

This black thermoplastic latch has a clean, flush appearance. The panel hole is always concealed.

Latch Body

Part Number: 8404-600-BK

Parts Selection

1. Smooth and snug pawl closure is assured by designing the depth of the support edge so that Grip equals $.25" \pm .005"$ ($6.35 \pm .13$ mm)
2. Selecting the appropriate snap clip in the table to the right accommodates panel thickness from $.043"$ to $.083"$ (1.09 to 2.11 mm).

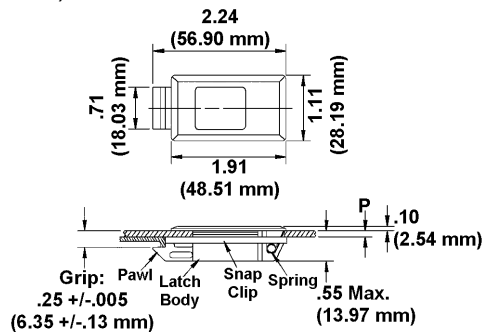

Installation

1. Place latch body, pawl end first, into panel hole.
2. Push back (spring) end of latch body into hole.
3. Slide appropriate snap clip (see table) onto latch body underside, starting at pawl end.

Snap Clip

Part Number: See Table

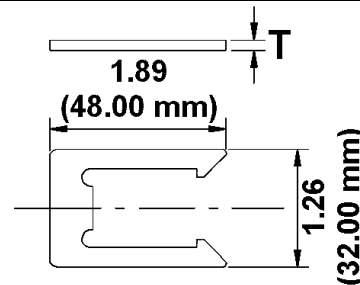

P Panel Thickness		T Snap Clip Thickness		Snap Clip Part Number
(inch)	(mm)	(inch)	(mm)	
.043 – .051	1.09 – 1.30	.125	3.18	8404-812-BK
.055 – .067	1.40 – 1.70	.110	2.79	8404-816-BK
.071 – .083	1.80 – 2.11	.095	2.41	8404-820-BK

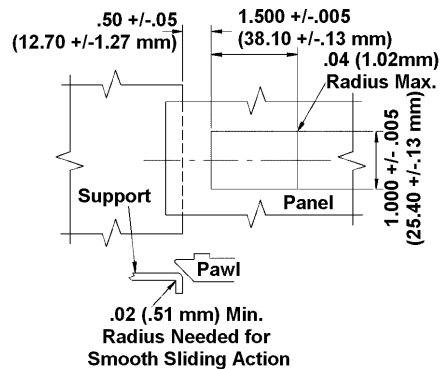

Series 8415 Slide Latch



Slide latch, bushing, and spacer ordered separately

DFCI Slide latch parts consist of a sliding bar assembly, a bushing, and spacers. The sliding bar assembly is attached to the removable panel and the bushing is mounted to the panel's stationary support. When closed, the spring action of the bar resists opening under vibration and shock loads.

Material: Steel, zinc plated
Finish: yellow chromate (-Z3Y)

Also available in all Stainless Steel 300 series; change the finish suffix to "-SS". (Spacers not available in stainless steel.)

All parts also available in steel with bright commercial chrome plate. Change the finish suffix to KBC. (Spacers not available in chrome.)

Bushing Installation Methods

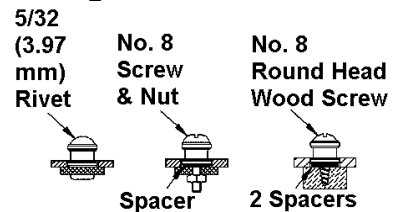

The latch is also available with the handle pointing downward for mounting on the underside of the panel. Clearance above the slide latch need only allow for fingers to grip the sliding bar.

Dim.	(inch)	(mm)
A	1.575	40.01
B	1.122	28.50
C	.177	4.50
D	.590	14.99
F	.295	7.49
G	.709	18.01
ØH	.134	3.40
I	.669	16.99
J	.453	11.51

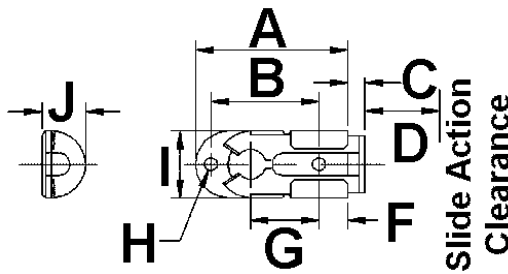

Dimension D is the Slide Action Clearance

Fasten bushing using any of the above methods. Fasteners for bushing are not supplied.

Use of spacer 8415-04-Z3Y is dependent upon panel thickness. See table at the left.

Inside diameter of bushing and spacer: .173" (4.39 mm)

Spacer Call-Up		
Panel Thickness		8415-04-Z3Y
(inch)	(mm)	Spacers Required
.046 - .080	1.17 - 2.03	None
.081 - .128	2.06 - 3.25	One
.129 - .160	3.28 - 4.06	Two

Part Selection	
Description	Part Number
Assembly	8415-Z3Y
Assembly, Handle down	8415-10-Z3Y
Bushing	8415-03-Z3Y
Spacer	8415-04-Z3Y

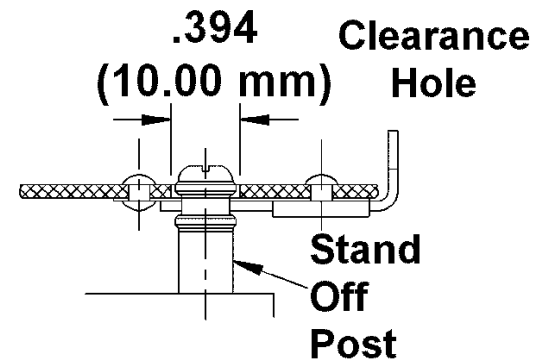
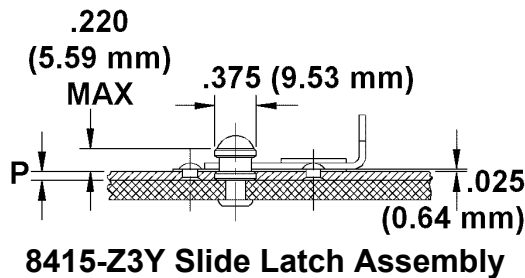

Slide / Push



AR-4610-Push to Lock Plastic



AR-4610 Plastic Fasteners consist of a stud and a receptacle assembly that is self-retained in a square hole in the fastened panel. **AR-4610 Fasteners** close by pushing the stud inward with finger pressure and open with a quarter-turn of the stud. **AR-4610 Fasteners** pass through a square hole in the support material, where its four prongs lock as they are expanded by the stud.

Material:

Acetal copolymer resin. Material burning rating code UL 94 HB.
ASTM E-162 flame spread index: 130.
Standard color is black.

Mechanical:

Designed Max. Axial Load: 11 lb.
Ultimate Axial Load: 56 lb.
Designed Max. Shear Load: 28 lb.
Ultimate Shear Load: 140 lb.
Operating Temperature: -20° to 180° F (-29° to 82° C)

	Part Numbers: 4600-701-BK 4601-701-BK		Part Numbers: 4600-711-BK 4601-711-BK		Part Numbers: 4600-721-BK 4601-721-BK
---	--	---	--	---	--

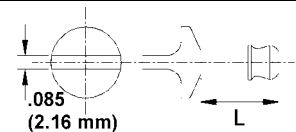
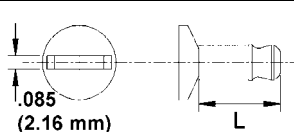
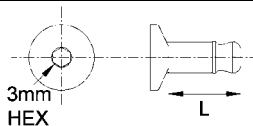

Fastener Selection

1. Choose the receptacle that fits your panel thickness (P).
2. Check that the combined thickness of your panel and support (T) is within listed limits.
3. Choose a stud head style and the part number, which corresponds to either the 4600 or 4601 series receptacle selected.

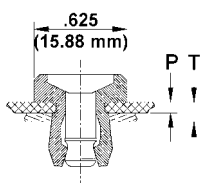

LOCKED

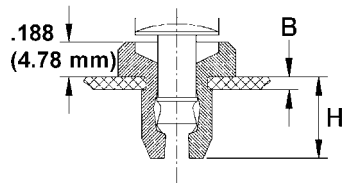

RELEASED

Top Panel:
.360" +.005"
(9.14 +.13 mm)
Square

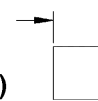

Bottom Panel:
.375" +.005"
(9.53 +.13 mm)
Square

Installation Procedure

AR-4610 studs and receptacles are packed separately. The receptacle is easily snapped into a square hole from the front panel and becomes self-retained. The stud is then pushed into the receptacle until it snaps in place. A small plastic mallet may be convenient for stud insertion.

Stud Selection

Head Style	For Use With Receptacle Series	Part Number	L	
			(inch)	(mm)
Hex	4600	4600-701-BK	.50	12.70
	4601	4601-701-BK	.55	13.97
Slot	4600	4600-711-BK	.50	12.70
	4601	4601-711-BK	.55	13.97
Knob	4600	4600-721-BK	.50	12.70
	4601	4601-721-BK	.55	13.97

Receptacle Selection

Panel Thickness P		Panel Plus Support T		Part Number	Undercut B		Length Under Head H	
(inch)	(mm)	(inch)	(mm)		(inch)	(mm)	(inch)	(mm)
.020 - .070	.51 - 1.78	.080 - .200	2.03 - 5.08	4600-802-BK	.070"	1.78	.48"	12.19
.071 - .125	1.80 - 3.18	.135 - .250	3.43 - 6.35	4601-802-BK	.125"	3.18	.54"	13.72

AR-4610 / SL-8400 -4

DFCI © is a registered trademark of DFCI Solutions, Inc.
Copyright ©2002-2005 by DFCI Solutions, Inc. All rights reserved.